



OWNERS:-
 1. SRI. DIPAK SINGHA.
 2. SRI. SAMIR SINGHA.
 3. SRI. AMIT SINGHA.
 SERIAL NO. 1 TO 3 ARE S/O. SRI. KALIDAS SINGHA.
 4. SRI. GANESH ROY.
 5. SRI. HITESH ROY.
 SERIAL NO. 4 TO 5 ARE S/O. SRI. SURENDRA NATH ROY.
 ALL ARE RESIDENT OF HELAPAKURI JOTE,
 P.O. NEW RANGIA, P.S. MATIGARA, DIST. - DARJEELING,
 PIN 734013

LAND AREA = 5002.97 SQM.
 OR, 74.8 KATHAS OR, 1.236 ACRE

LAND SCHEDULE :-

MOUZA :- JITU,
 J.L.NO. :- 69.
 SHEET NO. :- 2
 KHATIAN NO. :- L.R. 200/4, 2019, 44 /1 & 2018, 1842 (OLD)
 2676, 2679, 2680, 2681, 2682,
 2781, 2782, 2783, 2729, 2779 (NEW)
 PLOT NO. :- R.S. 216, 217, 219
 L.R. 708, 706/ 784, 707,
 P.S. :- MATIGARA,
 DIST. :- DARJEELING.
 G.P. :- ATHARAKHAI G.P.

Mouza Map

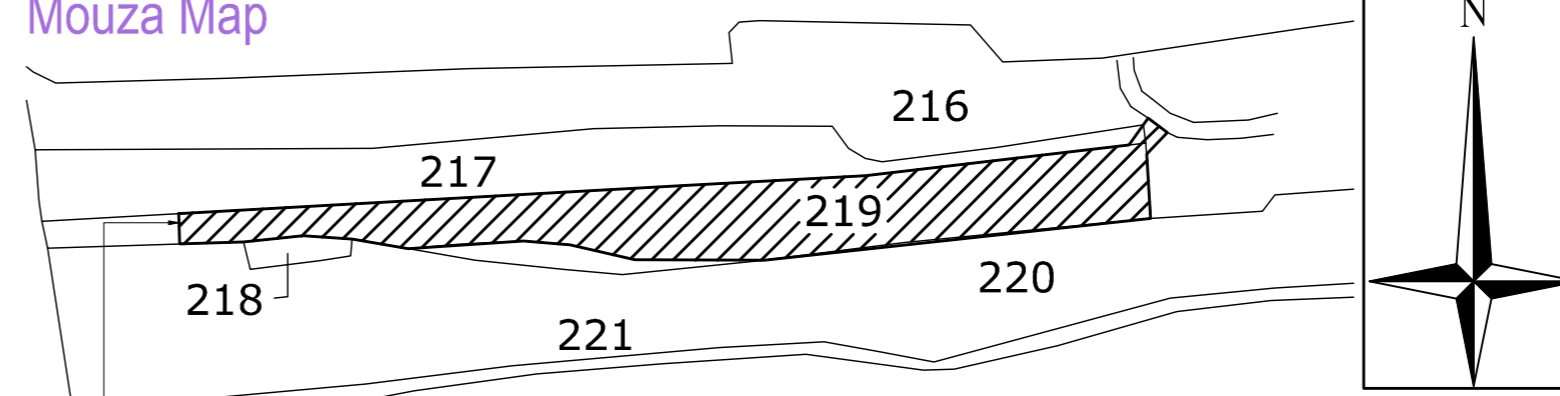

PROP. SITE
 PART TRACE MAP OF MOUZA JITU, J. L. NO. 69,
 SHEET NO. 2, P.S. MATIGARA, DIST. DARJEELING,
 SCALE.:- 16"= 1 MILE, PROPOSED PLOT SHOWN.

Location Plan

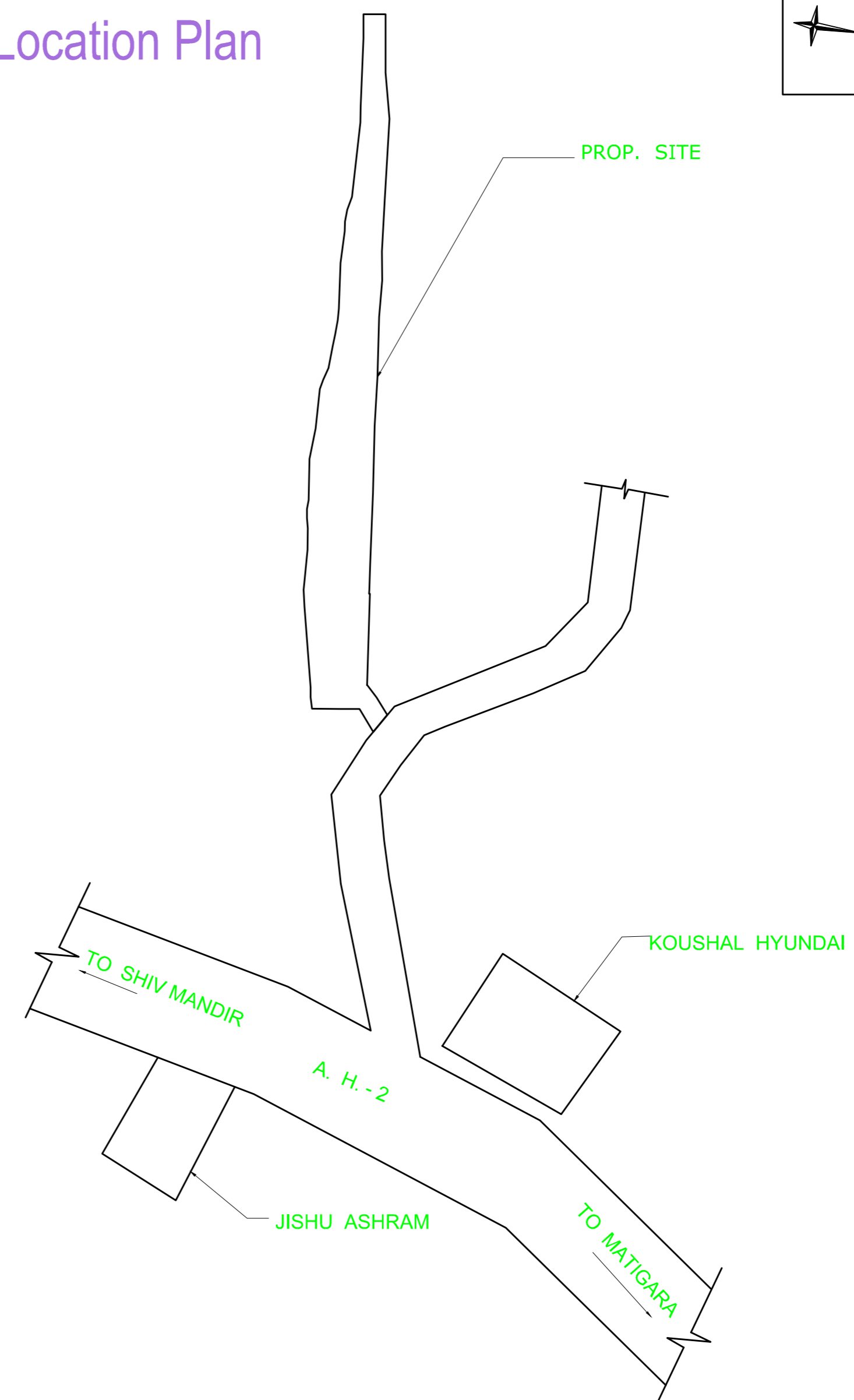

LOCATION MAP
 N.T.S

SIG. OF OWNERS

DRAWN BY....

LAND OF SRI HEMANTA SINGHA

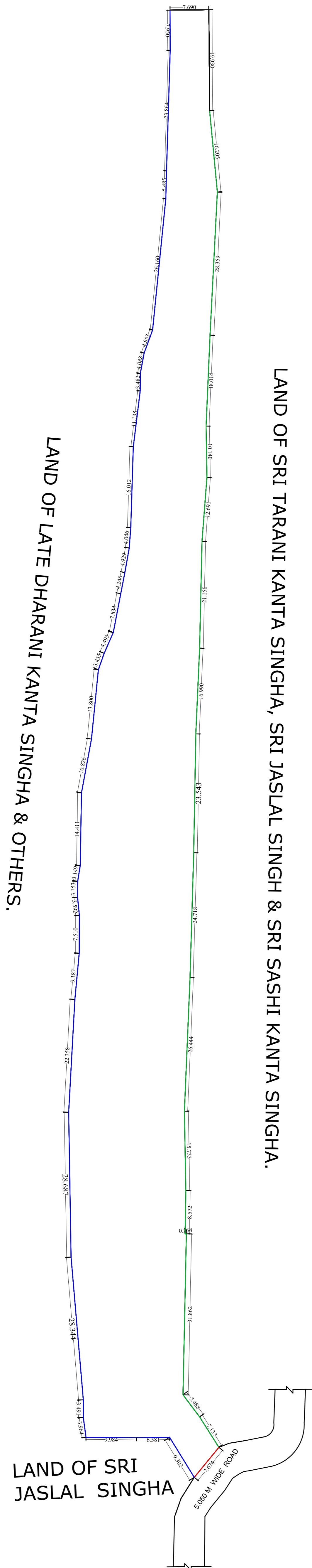

SITE PLAN
 SCALE 1:1 FOR DRAWING
 1:100 FOR PRINT



GREEN ELEGANCE
CONNECTIVITY | ELEGANCE | COMFORT

COZY NEST LLP



1.	26°43'3.73"N	88°22'18.83"E
2.	26°43'4.44"N	88°22'19.04"E
3.	26°43'3.73"N	88°22'08.49"E
4.	26°43'3.48"N	88°22'08.52"E

PROJECT :

RESIDENTIAL BUILDING AT, R.S. PLOT NO.- 216, 217, 219, L.R. PLOT NO.- 706 / 784, 707, 708 , L.R. KHATIAN NO. - 200/4, 2019, 44/1 & 2018, 1842 (OLD) 2676, 2679, 2680, 2681, 2682, 2781, 2782, 2783, 2729, 2779 (NEW), MOUZA - JITU , J.L. NO. - 69 , SHEET NO.-2, P.S.- MATIGARA, DIST. - DARJEELING, G.P.-ATHARAKHAI G.P.

COZY NEST LLP

PARTNER

Signature Owner.

📍 NH - 31 Near koushal Hyundai
Opp. Jesu Ashram
Matigara, Siliguri

📞 9339361344